

USED ON	SCALE 1:2	TITLE Subsea Circular Ball Inclinometer, range 5°	DRAWING NUMBER 5648/5		
			ISSUE	AMENDMENT	DATE

Note:  
 Ball Inclinometer, ±5°, liquid filled.  
 Black Ceramic Ball, 12mm diameter  
 Temperature range : -10 to 50 °C  
 Yellow (RAL1004) anti reflective backing  
 Hi visibility black lines and numbers

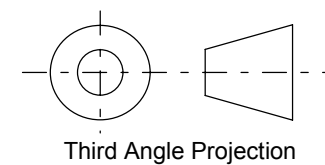
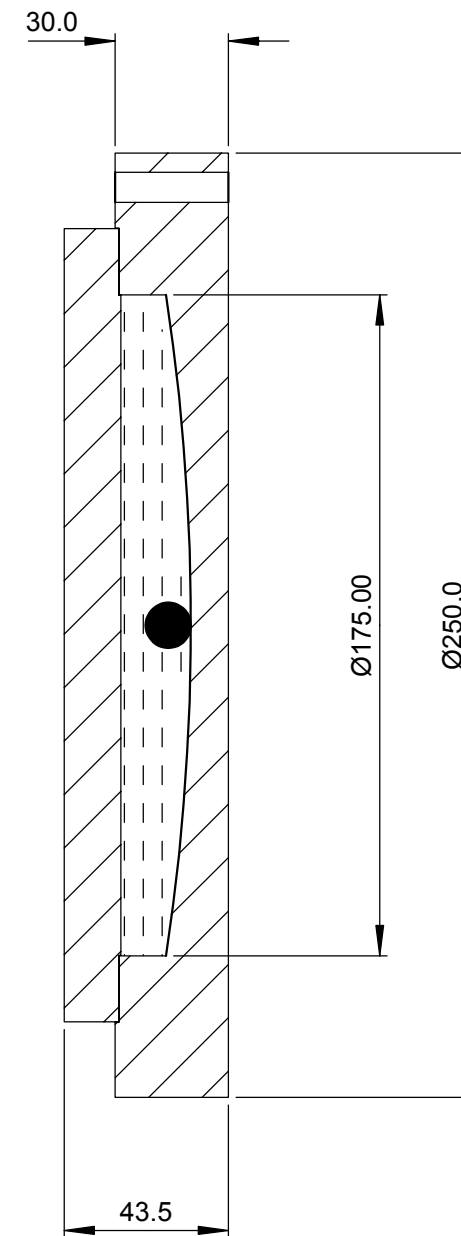
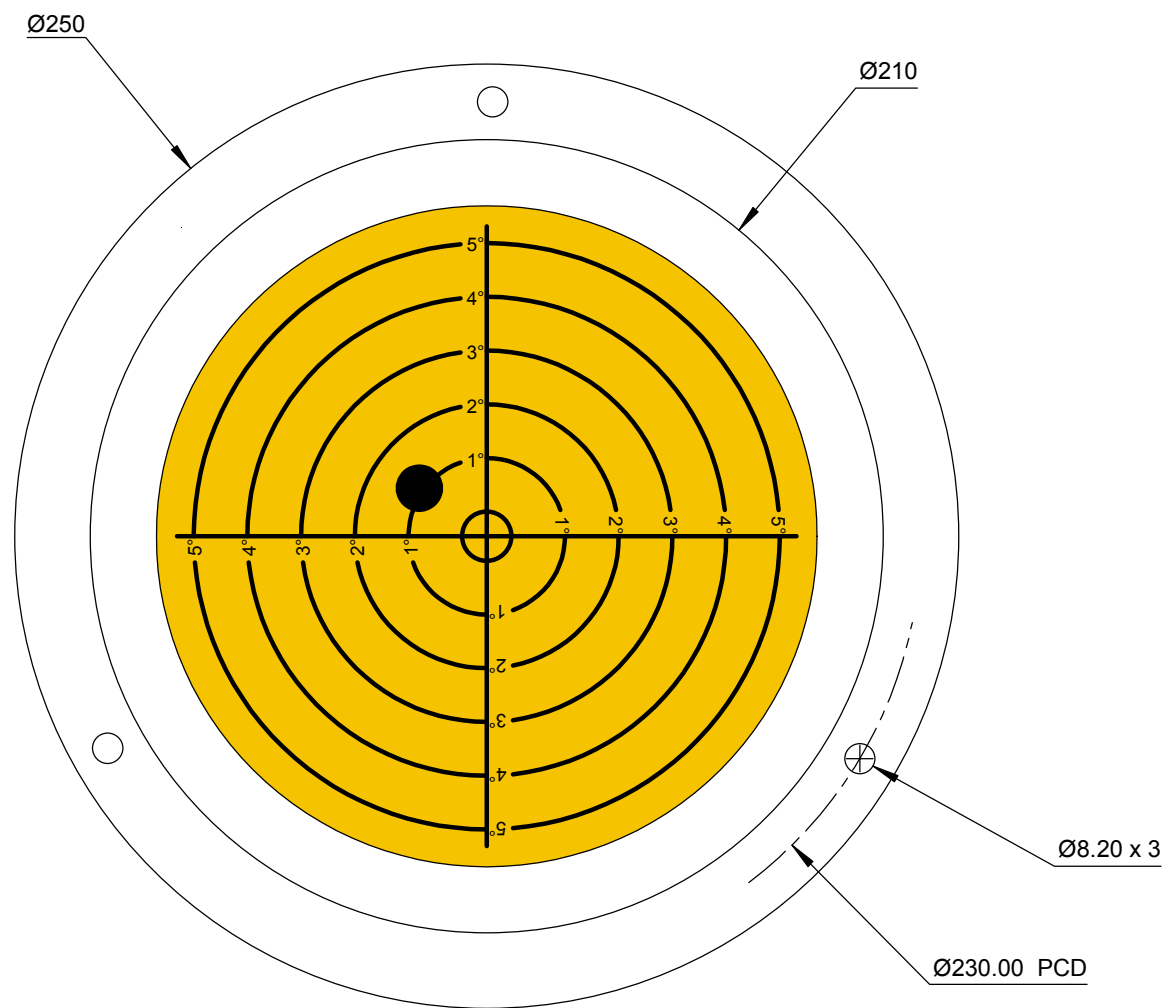

FINISH	TOLERANCES UNLESS STATED OTHERWISE (MM UNITS)	XX. ± 1.0	MATERIAL Cast Acrylic Sheet	LEVEL DEVELOPMENTS Croydon, Surrey, CRO 2DN	
		XX.X ± 0.25			
	XX.XX ± 0.1	DRAWN BY JHL	DATE 28/04/2009		