

USED ON	SCALE 1:2	TITLE Subsea Circular Ball Inclinometer, range $\pm 10^\circ$	DRAWING NUMBER 5648/6		
			ISSUE	AMENDMENT	DATE

Note:
 Ball Inclinometer, $\pm 10^\circ$, liquid filled.
 Black Ceramic Ball, 12mm diameter
 Temperature range : -10 to 50 °C
 Yellow (RAL1004) anti reflective backing
 Hi visibility black lines and numbers

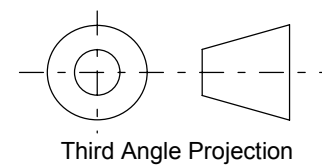
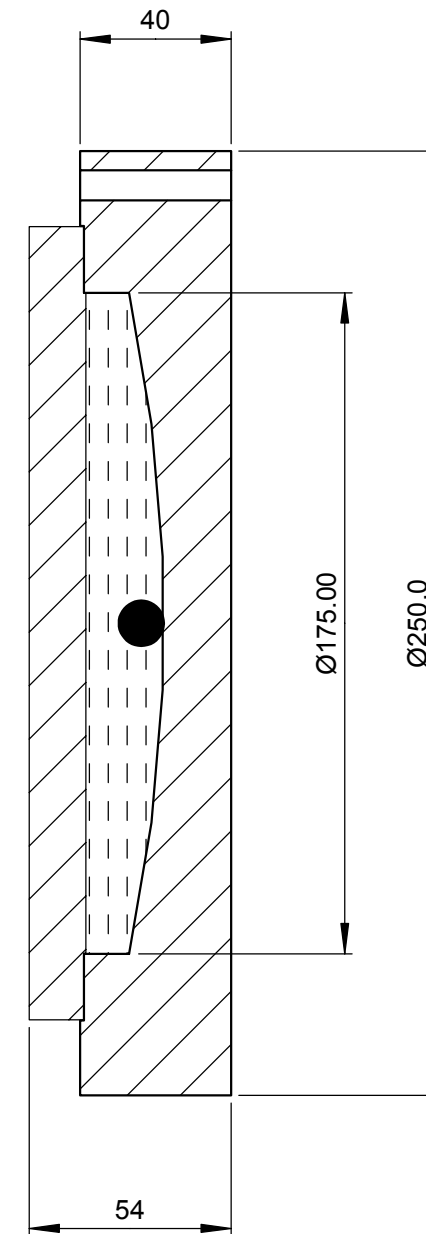
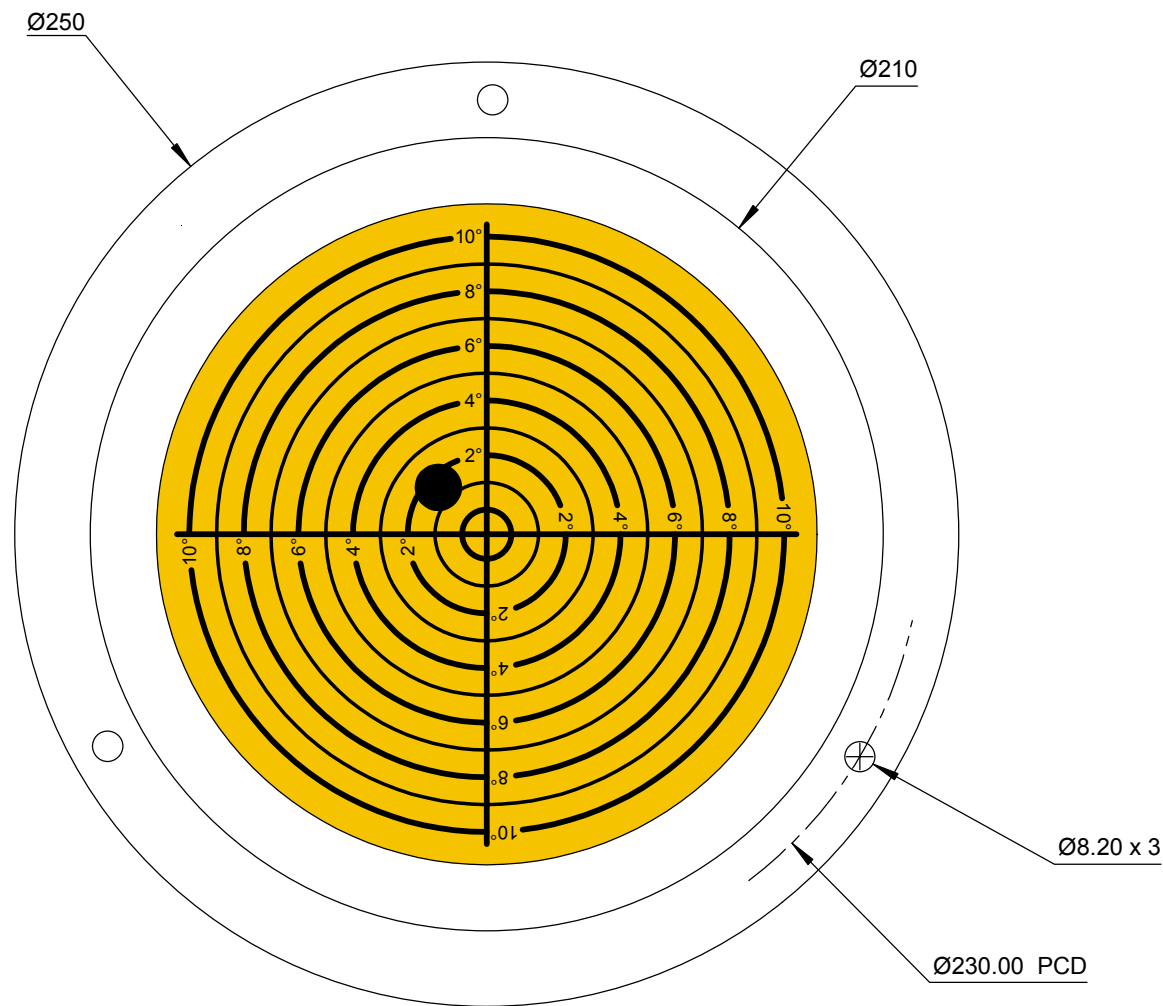

FINISH	TOLERANCES UNLESS STATED OTHERWISE (MM UNITS)	XX. ± 1.0 XX.X ± 0.25 XX.XX ± 0.1	MATERIAL	Cast Acrylic Sheet	
			DRAWN BY	JHL	DATE
			LEVEL DEVELOPMENTS Croydon, Surrey, CRO 2DN		