

USED ON	SCALE 2:1	TITLE Circular level , Ø12 x 5mm, 50'/2mm	DRAWING NUMBER 5801/1	
---------	--------------	--	--------------------------	--

ISSUE	AMENDMENT	DATE
0	Drawing opened for production	

Note :

Sensitivity : 50'/2mm, r=138mm
Temp. Range: -40 to +70°C

Centre Ring :

Outside diameter : Ø5.3mm
Colour : Black
Printed on inside surface of glass top lens

Bubble : Ø3.5 ±0.25 (@20°C)
Backing: White

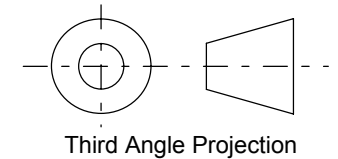
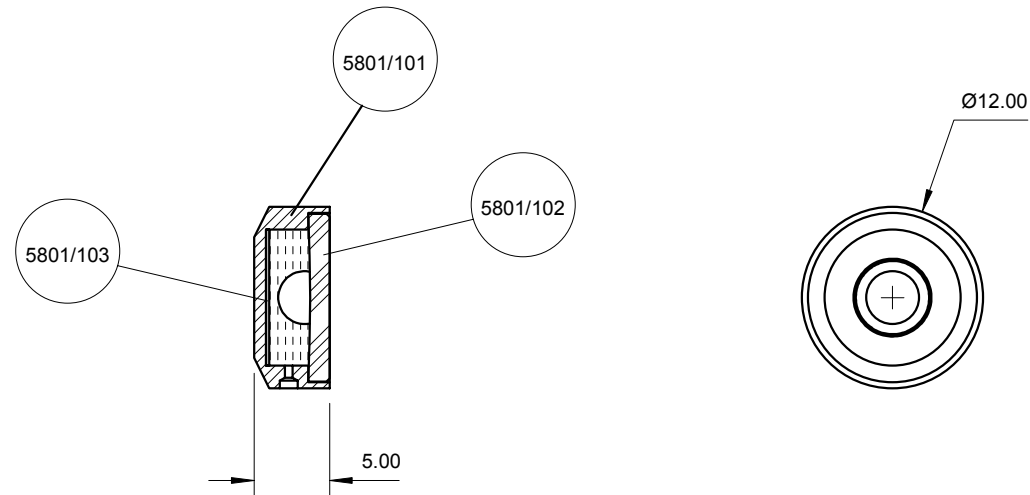

FINISH Black anodise	TOLERANCES UNLESS STATED OTHERWISE mm UNITS	XX. +/- 1.0 XX.X +/- 0.25 XX.XX +/- 0.1	MATERIAL Al body, glass top disc	LEVEL DEVELOPMENTS Croydon, Surrey, CRO 2DN	
			DRAWN BY M. Jones		