

Note:
 Ball Inclinator, $\pm 2^\circ$, liquid filled.
 Black Silicon Nitride ball, $\varnothing 1"$ (25.4mm)
 Temperature range: -10 to 50 °C
 White backing
 Hi visibility black lines
 Line width - 6mm
 Each ring represents 0.5°

Air bubble(s) may exist
 inside ($\leq 10\text{mm } \varnothing$), this
 does not affect quality or
 performance.

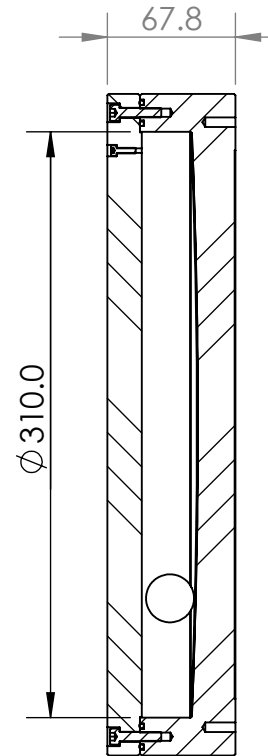

SECTION A-A

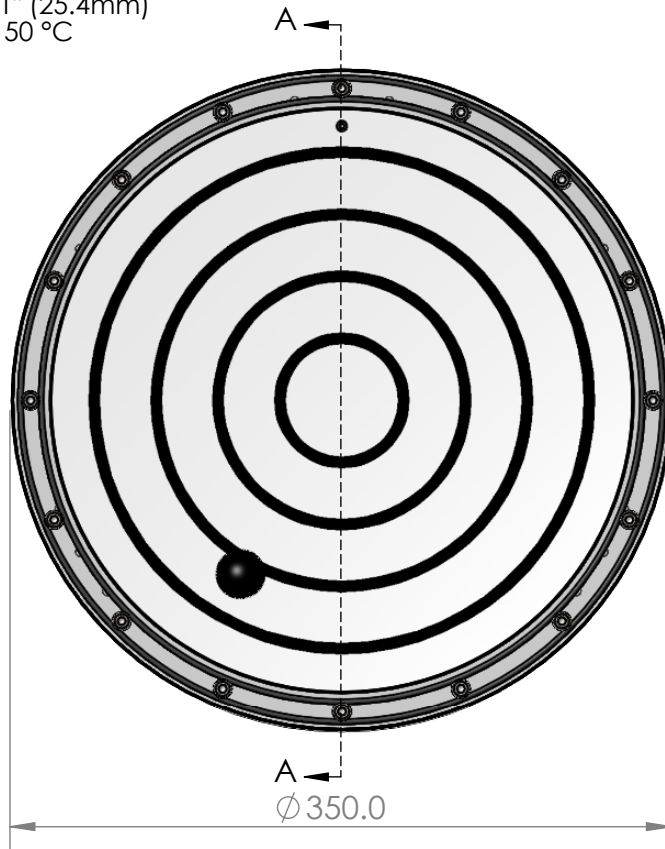
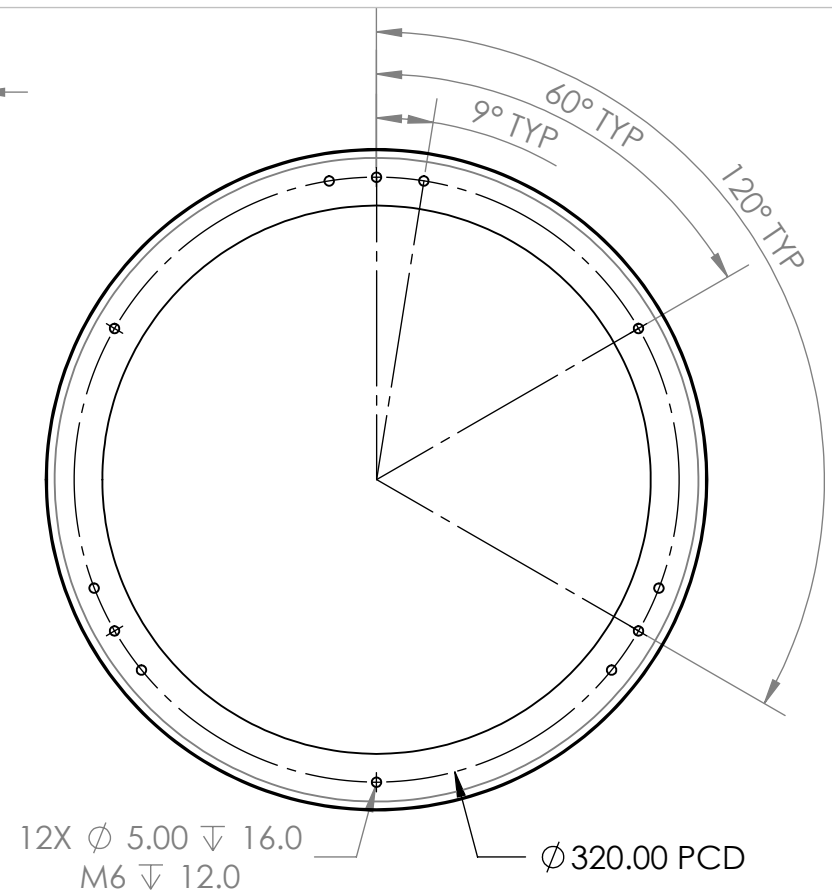

Storage and Handling Notice:

Exposure to rapid temperature
 change can introduce bubbles
 and/or affect their size.

Do not expose to large temperature
 gradients or store in direct sunlight.

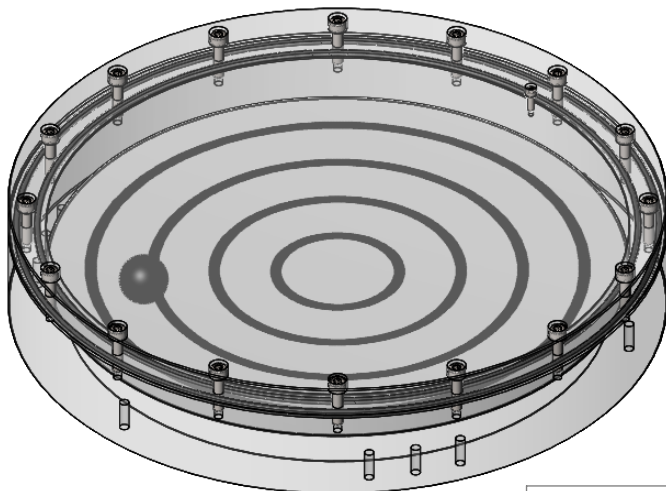

We reserve all intellectual property
 rights in connection with this document.
 Copyright © - Level Developments Ltd

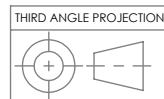

MATERIAL:
 Cast Acrylic

FINISH:

DRAWN NAME
 Jan Sandberg

Unless Otherwise
 Specified:
 Units: mm
 Tolerances:
 XX. ± 1.0
 XX.X ± 0.25
 XX.XX ± 0.1

DATE
 14/09/2015

level developments

FO055 - Issue 1



6	Updated with relevant notes	19/04/2022
5	665 6x M6 mounting holes added	23/04/2021
Issue	ECN Notes	Date
TITLE: Ø350mm Subsea Inclinometer, $\pm 2^\circ$		
DWG NO. 3722-1		A4
Used on: 6088-1		SCALE:1:4