

USED ON	SCALE 2:1	TITLE Bent vial type 13266	DRAWING NUMBER 5600/101		
---------	--------------	-------------------------------	----------------------------	--	--

ISSUE	AMENDMENT	DATE
-------	-----------	------

Note :
 Black ceramic lines, 0.35 wide (± 0.05)
 Lines are 165° around vial
 Bubble size 11.9 ± 0.3 at 70°F
 Clear liquid filling
 No visible scratches on glass surface
 Sensitivity : $15' \pm 3'$ per 2mm bubble movement

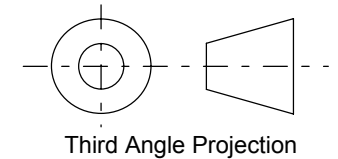
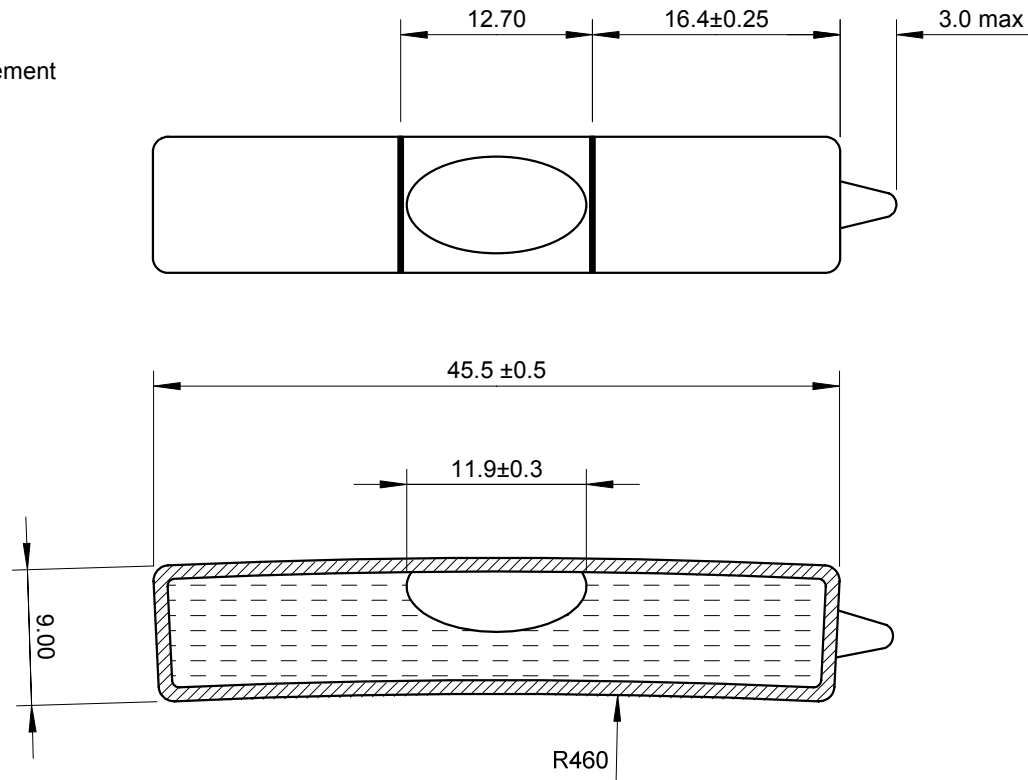

FINISH	TOLERANCES UNLESS STATED	XX. +/- 1.0	MATERIAL Soda Glass, $\varnothing 9 \times 0.9\text{mm}$	LEVEL DEVELOPMENTS Croydon, Surrey, CRO 2DN	
	OTHERWISE	XX.X +/- 0.25			
	mm UNITS	XX.XX +/- 0.1			