

1. Yellow backing
2. Black ball
3. Water proof
4. Accuracy  $\pm 10\%$
5. Temp range  $-20$  to  $+60^{\circ}\text{C}$

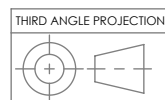
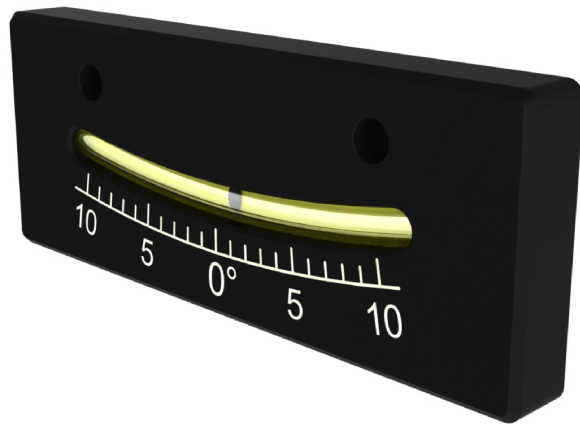
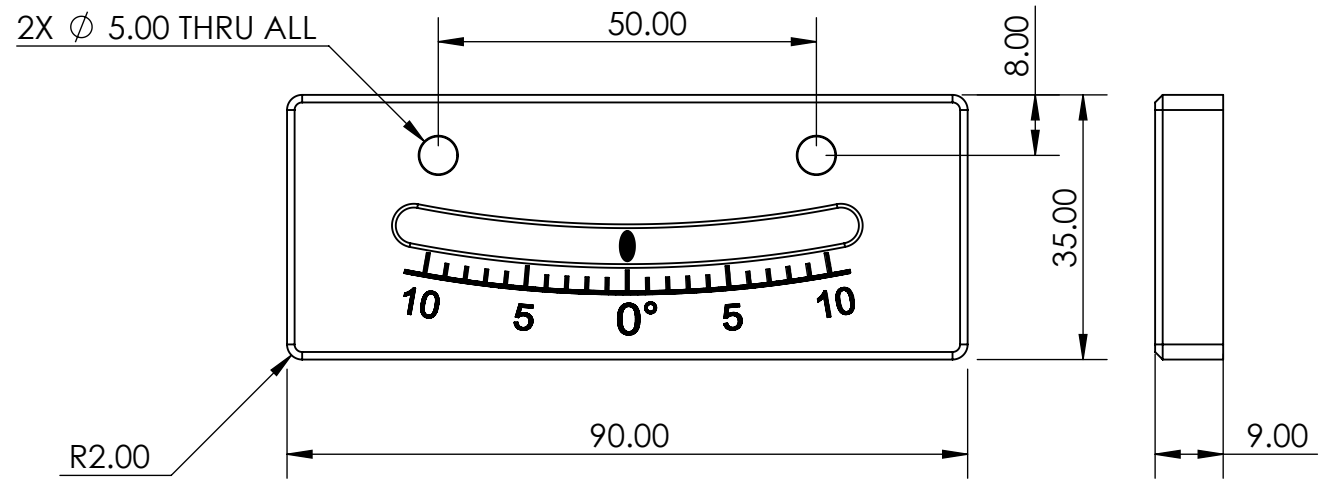

Unless Otherwise Specified: Units: mm Tolerances: XX. ± 1.0 XX.X ± 0.25 XX.XX ± 0.1	FINISH:	DEBUR AND BREAK SHARP EDGES
----------------------------------------------------------------------------------------------------	---------	-----------------------------------

	NAME	SIGNATURE	DATE
DRAWN	Jan Sandberg		05/05/2017
CHK'D			
APPV'D			
MFG			
Q.A			

 <b>level developments</b>
MATERIAL: Aluminium housing Glass tube

1	Opened for production	05/05/2017
Issue	ECN	Notes
Date		
TITLE: <b>BI10 - Ball inclinometer +/-10 degrees</b>		
DWG NO.	<b>6053-2</b>	A4
Used on:	SCALE:1:1	SHEET 1 OF 2

DO NOT SCALE DRAWING

FO027 - Issue 2