

- 1) Anti-reflective yellow backing
- 2) Pressure tested to 6000m seawater
- 3) Black ceramic ball (Ø14.3mm)
- 4) Liquid filled cavity
- 5) Range ±10°, accuracy ±0.5°
- 6) Weight in air 2.4Kg
- 7) Weight in seawater 0.43Kg
- 8) Operating Temperature -5°C to 50°C
- 9) Storage Temperature -5°C to 50°C

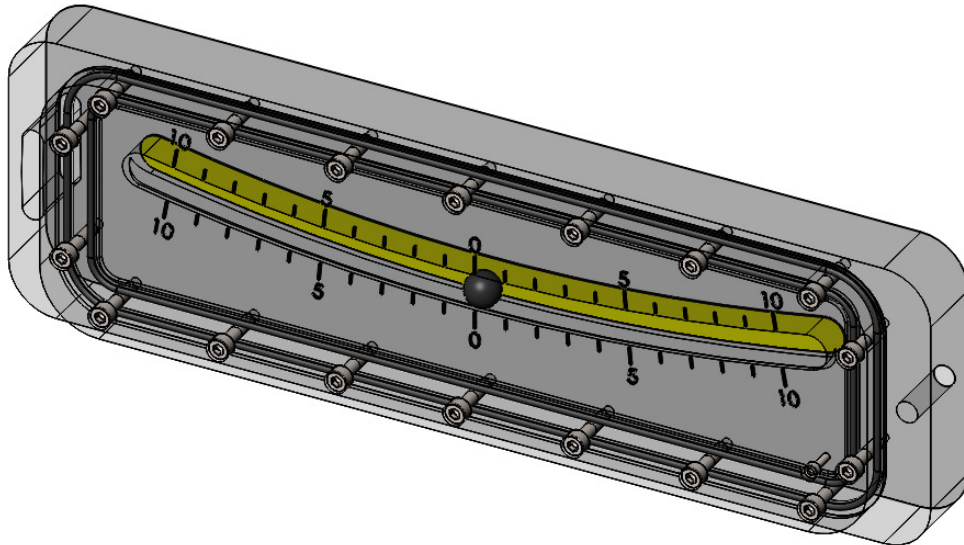
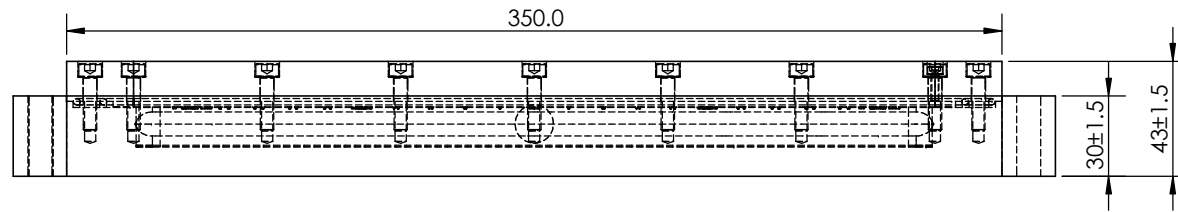
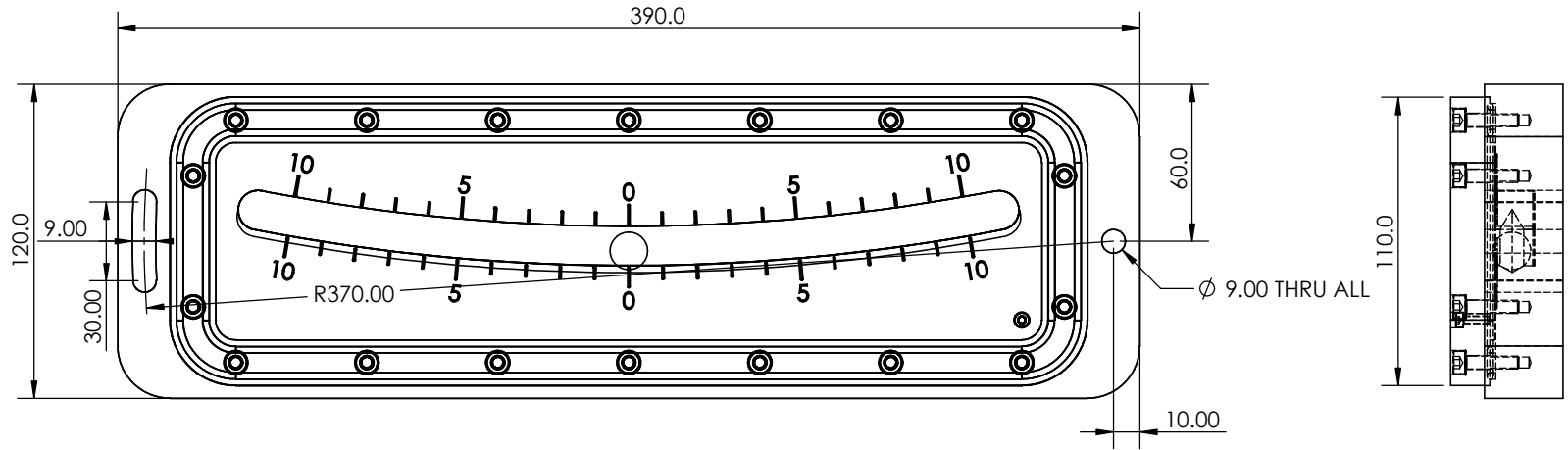

Issue	ECN	Notes	Date
4	0	Note amended - pressure tested to 6000m seawater (was 2500m)	15/09/2014
3	0	Added notes for storage & operating temperature	14/07/2014
2	0	Corrected dimensions related to material tolerances	26/06/2014
1	0	Opened for production	30/05/2014

Unless Otherwise Specified:
 Units: mm
 Tolerances:
 XX ± 1.0
 XX.X ± 0.25
 XX.XX ± 0.1

FINISH:

DEBUR AND
 BREAK SHARP
 EDGES

	NAME	SIGNATURE	DATE
DRAWN	Jan Sandberg		30/04/2014
CHKD			
APPVD			
MFG			
Q.A			



MATERIAL:
 PMMA (Cast Acrylic)

TITLE:
 Subsea Single Axis Ball Inclinometer, ±10°

DWG NO. **6066-1** A4

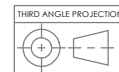

DO NOT SCALE DRAWING

FO026 - Issue 2

Used on: SCALE:1:2 SHEET 1 OF 1