



Features

- Dual axis measurement
- Full scale range from $\pm 10^\circ$ to $\pm 60^\circ$
- Solid state MEMS sensor
- 0-5V or 0-10V analogue output for each channel
- Frequency response 1Hz
- Small size, 46 x 39 x 10.5mm
- Sealed to IP67
- 5 core 2m PUR cable with 5 pin M12 Connector
- Factory configurable to suit most applications

Applications

- Single and dual axis PV Solar Trackers
- Security systems
- Platform levelling and monitoring
- GPS compensation
- Platform scales and weigh bridge levelling
- Agricultural and industrial vehicle tilt monitoring
- Telescopic and scissor lift platform monitoring
- Can be readily customised for most applications



Description

The LCH-A-D is a low cost dual axis inclinometer sensor supplied in a sealed machined Aluminium housing with a 2m M12 Cable. It has an analogue interface for each of the X and Y measurement axis. A PCB only version is also available (part number LCP-A-D). These devices are manufactured and calibrated in our UK factory to guarantee performance to the stated specification.

Specifications

Parameter	Value	Unit	Notes
Supply Voltage	7-30	V	For 0.5-4.5V analogue output range devices.
	12-30	V	For 0.5-9.5V analogue output range devices. Internal circuit protects from transients and reverse polarity, however use of a low noise DC supply is recommended to ensure the best performance.
Operating Current	15	mA	Maximum value.
Output Impedance	100	Ω	
Operating Temperature	-40 to 85	$^\circ\text{C}$	
Size: Width Length Height	46.0 39 10.5	mm	
Measuring range	± 10 to ± 60	$^\circ$	Full scale measuring range is selected by part numbering (see page 4).
Zero Output Voltage	2.5	V	For 0.5-4.5V analogue output range devices.
	5	V	For 0.5-9.5V analogue output range devices. Nominal output voltage when device is placed on a level surface.
Zero Bias Error	± 0.1	$^\circ$	Maximum zero offset angle when unit is placed on a level surface. For optimum zero point accuracy, the mounting angle of the part can be adjusted.
Zero Bias Temperature Error	0.02	$^\circ/\text{C}$	The maximum change in zero position output per $^\circ\text{C}$ of temperature change.
Sensitivity Temperature Error	0.01	$\%/^\circ\text{C}$	% Change in sensitivity per $^\circ\text{C}$ of temperature change.
Accuracy (20$^\circ\text{C}$)	± 0.3	$^\circ$	The maximum error between the measured and displayed value at any point in the measurement range (up to $\pm 45^\circ$) at room temperature (20 $^\circ\text{C}$).
Accuracy (-10 to 60$^\circ\text{C}$)	± 1	$^\circ$	The maximum error between the measured and displayed value at any point in the measurement range over the specified temperature range.
Long Term Stability	0.1	$^\circ$	1 year stability when device is powered continuously at 20 $^\circ\text{C}$.
Resolution (@1Hz BW)	0.05	$^\circ$	Smallest measurable change in output.
Low Pass Filter Freq.	1	Hz	Includes a second order low pass filter on the output with a 1Hz -3dB cut-off. The filter can be factory set to different values on request.
Mechanical shock	3000 (0.5ms)	g	Shock survival limit for MEMS sensor.
Cable Length	2	m	With 5 pin M12 Connector, Other lengths available on request.
Weight	24	g	Not including cable.



Dimension Drawing

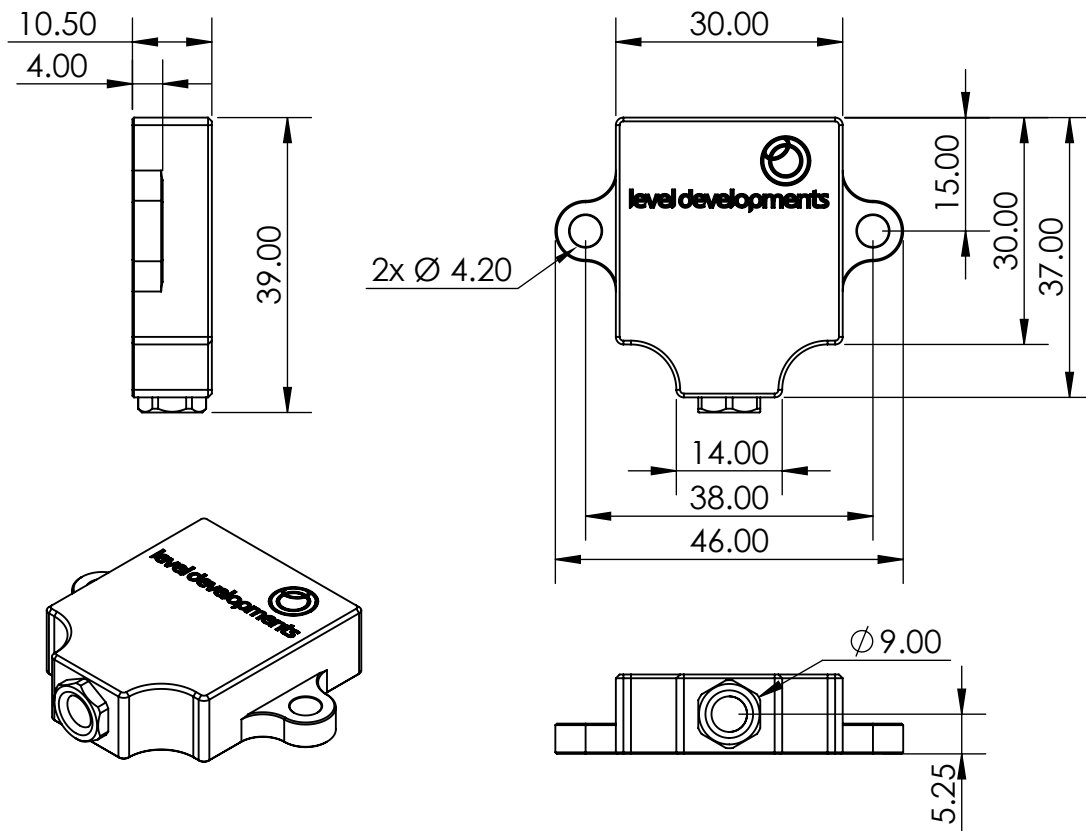

Axis Direction and Mounting Orientation For Dual Axis Use

Mounted on Horizontal Surface

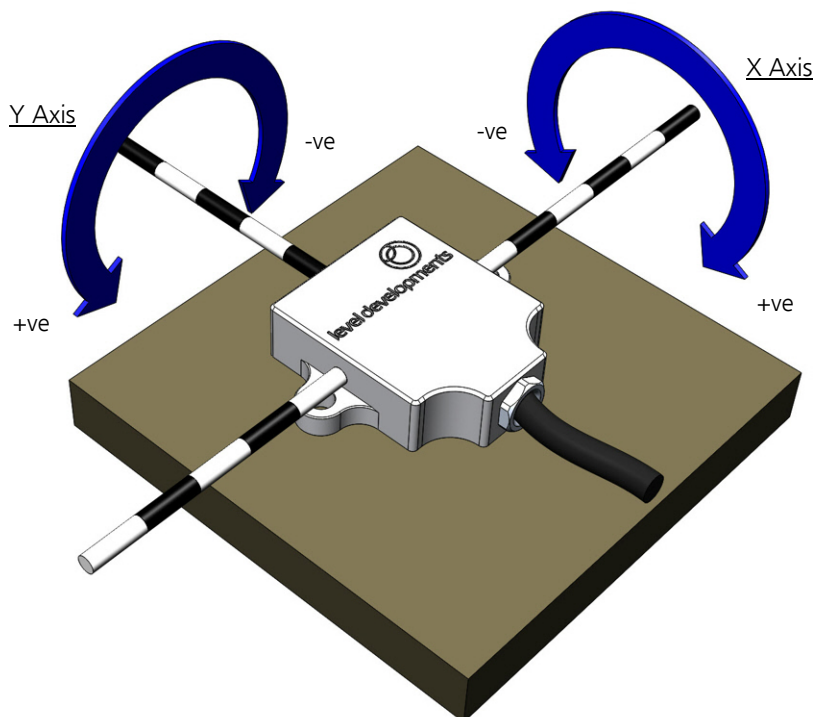



Cable and Connector Details

Parameter	Value
Connector description	M12 5-pin male
Connector make-up	Over-moulded
Coding	A-coded
Overall length	2 meters
Connector seal rating	IP67
Braided	Yes
Braid type	Tin plated Copper
Jacket material	PUR
Jacket diameter	4.7mm (max)
Wire Gauge	24 AWG
Conductor strands	41x0.08mm

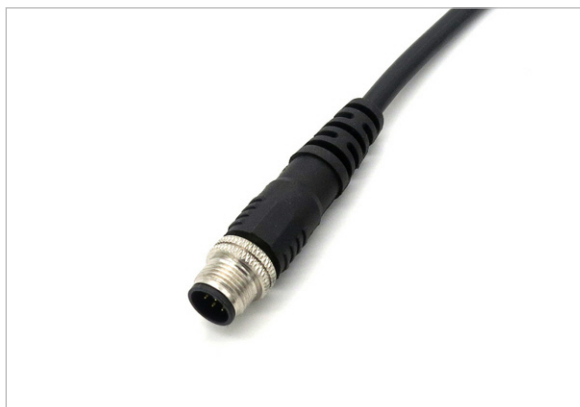

Pin Number	Internal Wire Colour	Function
1	Brown	+ve Supply
2	White	Y Axis Output
3	Blue	Gnd (0v)
4	Black	X Axis Output
5	Grey	Signal Gnd Analogue Output

M12 male connector
View from front:

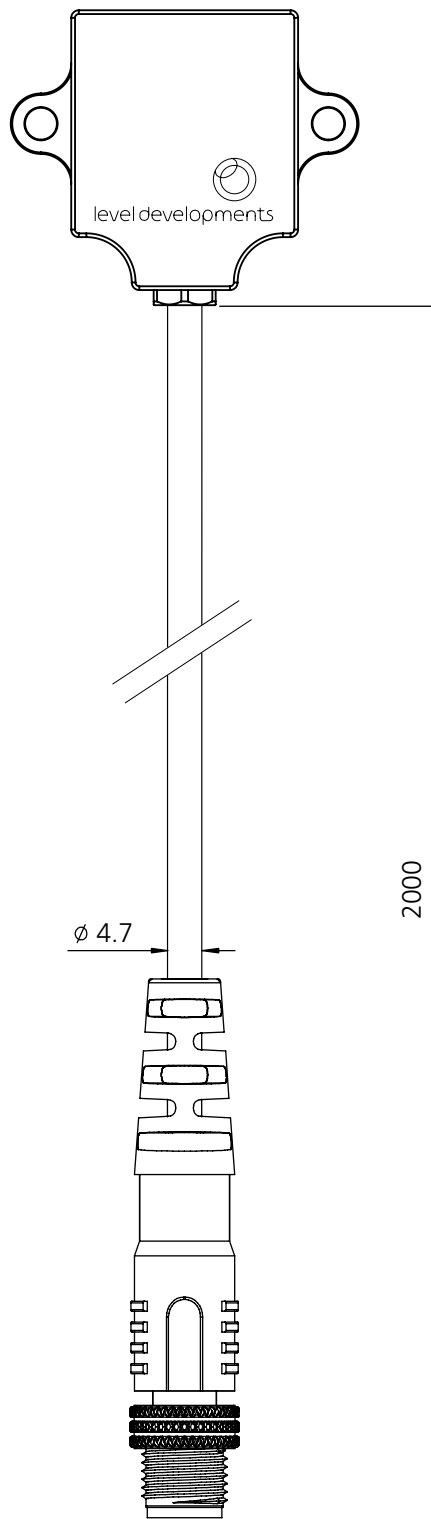
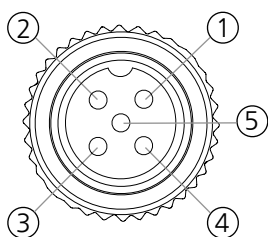



Voltage Output Change With Angle

All inclinometers measure a change in the effect of the gravitational field on a proof mass to derive angle. As the inclinometer sensor is rotated, the sensing element is subject to gravitational forces which move the proof mass, and this movement is detected and measured. In this inclinometer there are two sensing elements mounted perpendicular to one another so that the device can measure both the X and Y axis simultaneously. Internally these two sensors are measured and a processor derives the angular position. This angle is then converted to a voltage which is linear with the change in angle. In this device there are two output voltage stages, one for each of the measurement axis. As the angle is varied over the full scale range the output voltage changes between 0.5 to 4.5V or 0.5 to 9.5V depending on the part numbering (see page 4).

$$\text{Angle} = \frac{(V_{\text{out}} - V_{\text{offset}}) \times 1000}{SF}$$

Where

V_{out} is the measured voltage from the X or Y axis inclinometer output.

V_{offset} is the voltage at 0° which is 2.5V (see table)

SF is the Scale Factor in mV per degree (see table)

Part Number	Description	Scale Factor (SF)	Zero Output (V_{offset})
LCH-A-D-10-05	±10° Full scale range, 0.5 to 4.5V output	200mV/°	2.5V
LCH-A-D-15-05	±15° Full scale range, 0.5 to 4.5V output	133.3mV/°	2.5V
LCH-A-D-30-05	±30° Full scale range, 0.5 to 4.5V output	66.67mV/°	2.5V
LCH-A-D-45-05	±45° Full scale range, 0.5 to 4.5V output	44.44mV/°	2.5V
LCH-A-D-60-05	±60° Full scale range, 0.5 to 4.5V output	33.33mV/°	2.5V
LCH-A-D-10-10	±10° Full scale range, 0.5 to 9.5V output	450mV/°	5V
LCH-A-D-15-10	±15° Full scale range, 0.5 to 9.5V output	300mV/°	5V
LCH-A-D-30-10	±30° Full scale range, 0.5 to 9.5V output	150mV/°	5V
LCH-A-D-45-10	±45° Full scale range, 0.5 to 9.5V output	100mV/°	5V
LCH-A-D-60-10	±60° Full scale range, 0.5 to 9.5V output	75mV/°	5V

Example Graph Of Output (±10° Full Scale Range with 0.5 to 4.5V Output Range)

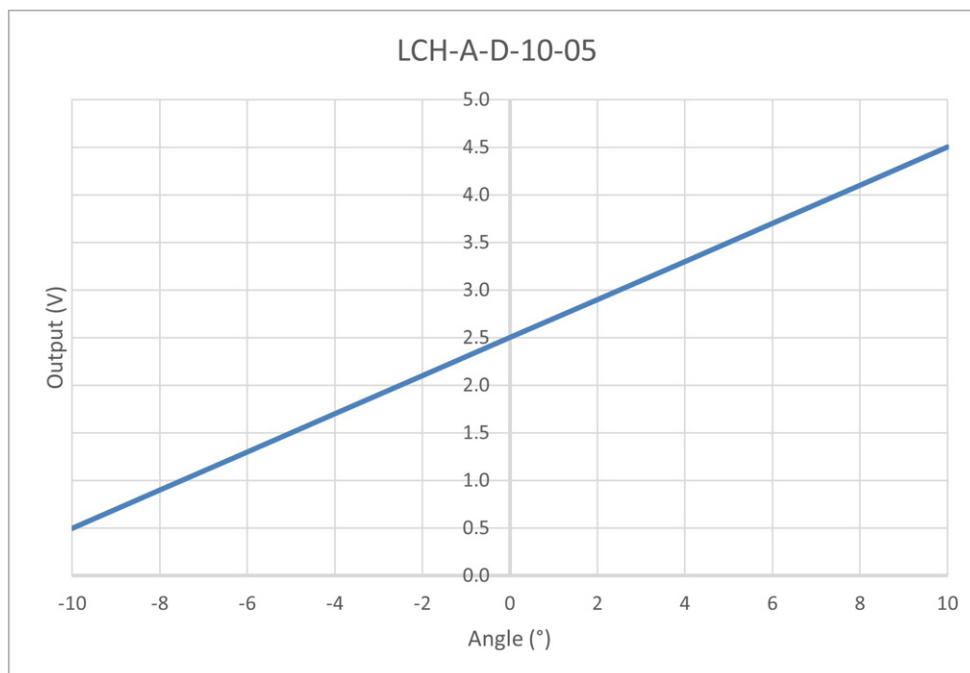



Part Numbering

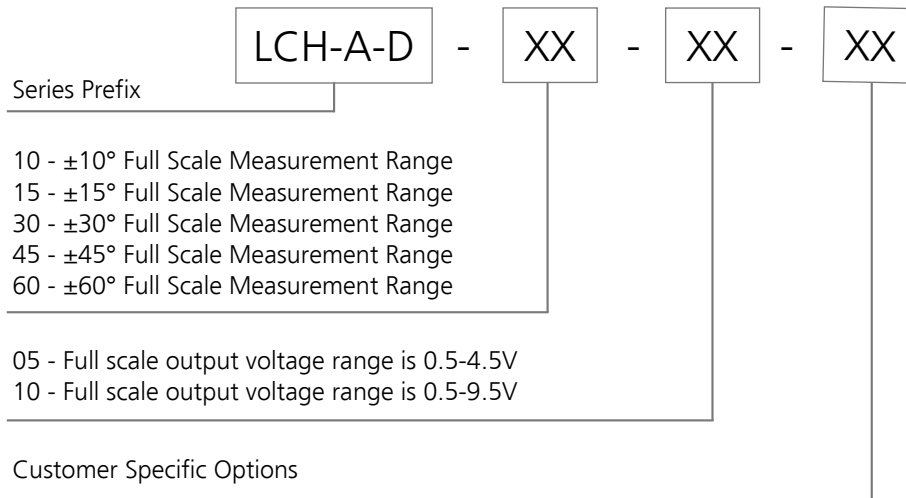

Example:

LCH-A-D-30-10

LCH-A-D Series Inclinometer
 $\pm 30^\circ$ Full Scale Measurement Range
0.5 to 9.5V full scale output

Product Options

1. Output Voltage range can be factory modified to suit most requirements
2. Output Voltage can be factory modified to be a Sine function of angle.
3. Standard cable length is 2m 5 pin M12, others are available on request.
4. Frequency response can be factory adjusted between 0.125 and 32Hz
5. Axis Orientation and directions can be factory modified.
6. Cable can be pre-assembled with mating connector for customers application.

Special order versions are generally only available for volume orders or ongoing requirements.

Certification

The products are type approved to in accordance with the following directive(s):

EMC Directive 2004/108/EC



And it has been designed, manufactured and tested to the following specifications:

BS EN61326-1:2006

BS EN55011:2007, Group 1
Class B

Electrical equipment for measurement, control and laboratory
use – EMC Requirements